

Title Number : ON91719

This title is dealt with by Land Registry, Gloucester Office.

The following extract contains information taken from the register of the above title number. A full copy of the register accompanies this document and you should read that in order to be sure that these brief details are complete.

Neither this extract nor the full copy is an 'Official Copy' of the register. An official copy of the register is admissible in evidence in a court to the same extent as the original. A person is entitled to be indemnified by the registrar if he suffers loss by reason of a mistake in an official copy.

This extract shows information current on 30 JUN 2011 at 17:13:30 and so does not take account of any application made after that time even if pending in the Land Registry when this extract was issued.

REGISTER EXTRACT

Title Number	: ON91719
Address of Property	: land on the west side of Sutton Wick Lane, Drayton
Price Stated	: Not Available
Registered Owner(s)	: THE PARISH COUNCIL OF DRAYTON care of 33 Bath Street, Abingdon, Oxon., OX14 3RL.
Lender(s)	: None

This is a copy of the register of the title number set out immediately below, showing the entries in the register on 30 JUN 2011 at 17:13:30. This copy does not take account of any application made after that time even if still pending in the Land Registry when this copy was issued.

This copy is not an 'Official Copy' of the register. An official copy of the register is admissible in evidence in a court to the same extent as the original. A person is entitled to be indemnified by the registrar if he suffers loss by reason of a mistake in an official copy. If you want to obtain an official copy, the Land Registry web site explains how to do this.

## A: Property Register

This register describes the land and estate comprised in the title.

OXFORDSHIRE : VALE OF WHITE HORSE

- 1 (16.01.1979) The Freehold land shown edged with red on the plan of the above Title filed at the Registry and being land on the west side of Sutton Wick Lane, Drayton.

## B: Proprietorship Register

This register specifies the class of title and identifies the owner. It contains any entries that affect the right of disposal.

Title absolute

- 1 (09.09.1985) Proprietor(s): THE PARISH COUNCIL OF DRAYTON care of 33 Bath Street, Abingdon, Oxon., OX14 3RL.

## C: Charges Register

This register contains any charges and other matters that affect the land.

- 1 The land is subject to rights of drainage and rights in respect of water gas electricity supply and telephone services.
- 2 A Transfer of the land in this title dated 1 October 1984 made between (1) David Herring Limited (Transferors) and (2) The Parish Council of Drayton (Transferees) contains the following covenants:  
-

"THE Transferees for themselves and their successors in title hereby covenant with the Transferor and their successors in title that they the Transferees will at all times hereafter use and maintain the land hereby transferred as and for the purposes of public open space and will keep the same in a neat and tidy condition and reasonably free from weeds at all times to the satisfaction of the Local Planning Authority."

End of register

# H.M. LAND REGISTRY

TITLE NUMBER

## ON91719

ORDNANCE SURVEY  
PLAN REFERENCE

COUNTY SHEET  
OXFORDSHIRE

NATIONAL GRID  
SU 4794

SECTION  
D

Scale: 1/1250 Enlarged from 1/2500 VALE OF WHITE HORSE DISTRICT

© Crown copyright 1983

Old Reference X 9 A

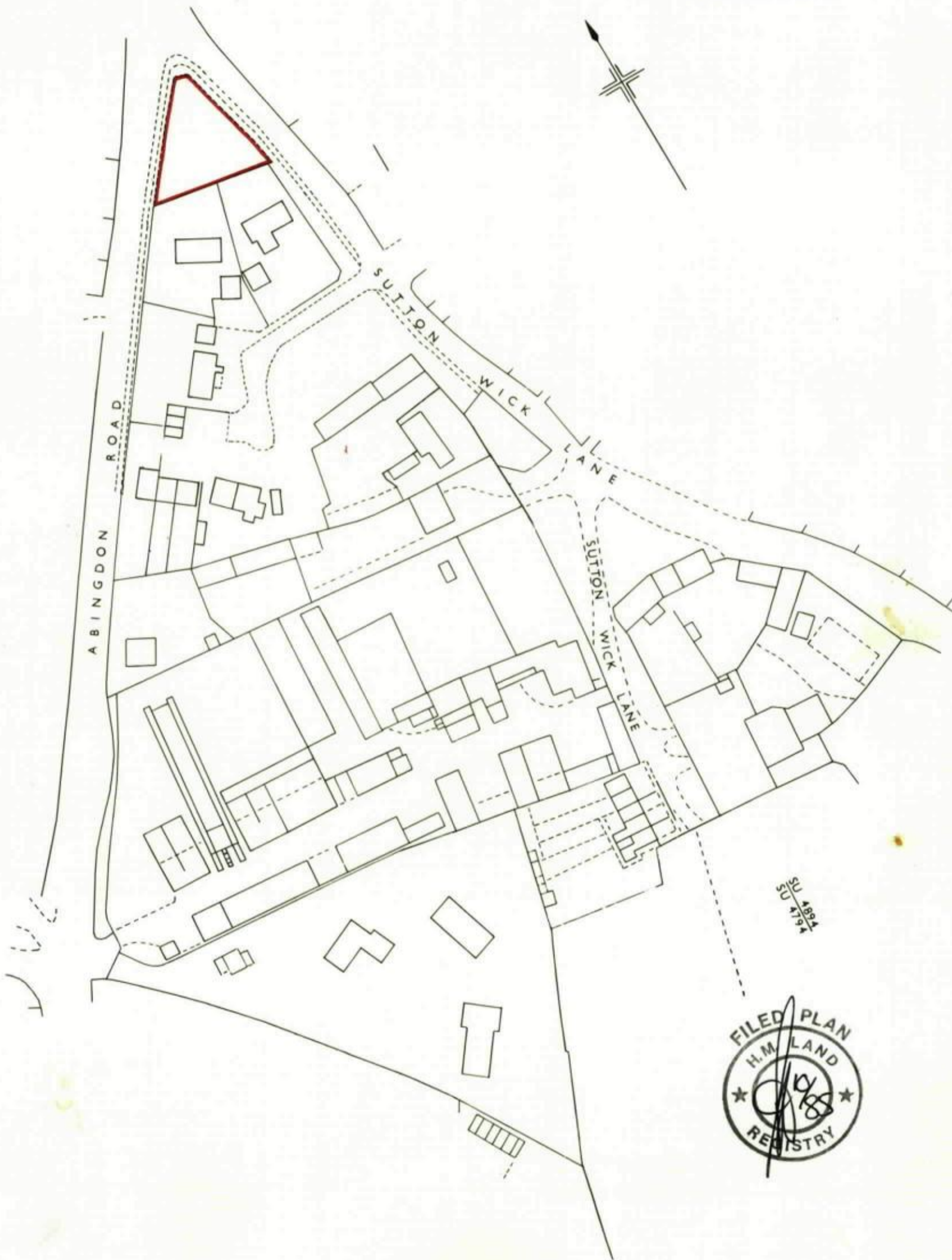

This is a copy of the title plan on 30 JUN 2011 at 17:13:30. This copy does not take account of any application made after that time even if still pending in the Land Registry when this copy was issued.

This copy is not an 'Official Copy' of the title plan. An official copy of the title plan is admissible in evidence in a court to the same extent as the original. A person is entitled to be indemnified by the registrar if he suffers loss by reason of a mistake in an official copy. If you want to obtain an official copy, the Land Registry web site explains how to do this.

The Land Registry endeavours to maintain high quality and scale accuracy of title plan images. The quality and accuracy of any print will depend on your printer, your computer and its print settings. This title plan shows the general position, not the exact line, of the boundaries. It may be subject to distortions in scale. Measurements scaled from this plan may not match measurements between the same points on the ground. See Land Registry Public Guide 7 - Title Plans.

This title is dealt with by Land Registry, Gloucester Office.

© Crown Copyright. Produced by Land Registry. Further reproduction in whole or in part is prohibited without the prior written permission of Ordnance Survey. Licence Number 100026316.